

SSB1

Speaker Mount Adaptor For TV Bracket

Item ref: 129.595UK

User Manual

Thank you for choosing the SSB1 speaker adaptor for TV bracket. This adaptor is designed to fit on any VESA standard TV bracket with a VESA width between 200 and 600. This eliminates the need for additional drilling.

Caution:

Please read this manual thoroughly to avoid damage to property or personnel. If unsure of any part of this manual please refer to professional installer for help:

- This product contains small components that could pose a choking hazard if swallowed, please keep out of reach of children.
- This product is designed for mounting on to a TV bracket. Please ensure your existing TV bracket is capable of supporting the weight of this adaptor plus your TV and speakers.
- Safety gear such as gloves and safety goggles must be worn during the installation. A minimum of two people are required throughout the installation, failure to do so may result in injury or damage.
- This product is design for indoor use only. The bracket must be inspected at least every two months for loose joints or aged parts.

Contents:

Please check all contents listed below are included inside the box. If anything is missing please return to the retailer or dealer.

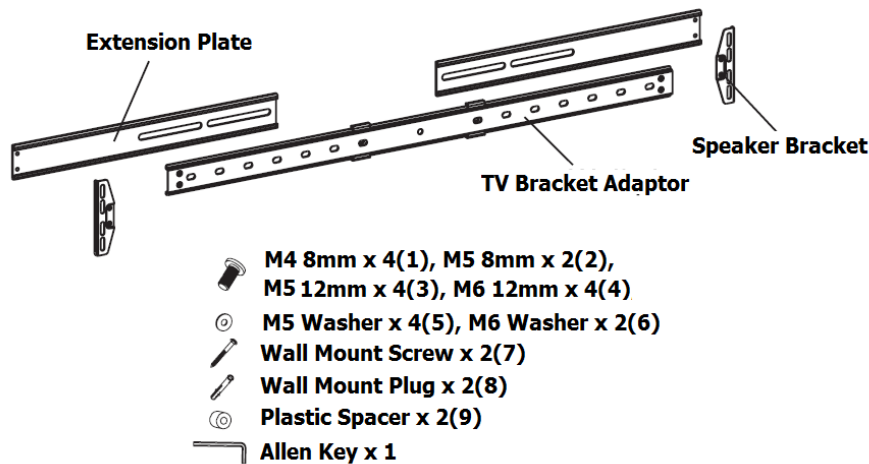

Step 1 – Assemble the bracket as shown below.

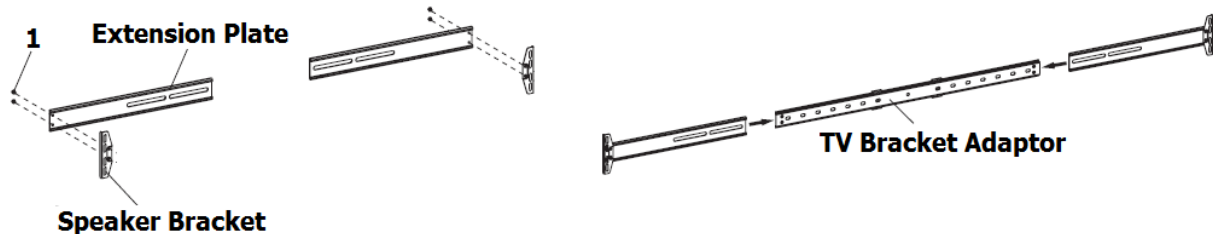

Step 2 – Attach the speakers to the speaker brackets, only use washer (5) if M5 screw (3) is used. Check the mounting VESA width of your TV and adjust width of the bracket accordingly, lock the width with supplied Allen key and M5 screw (2).

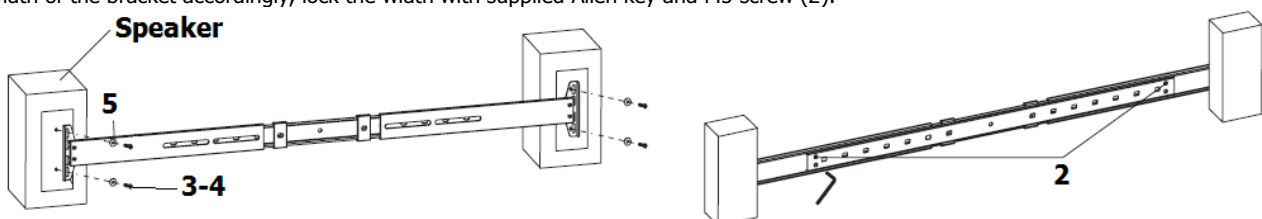

Step 3 – Install the adaptor between the TV and TV bracket as shown below, use spacer (9) on the top mounting points.

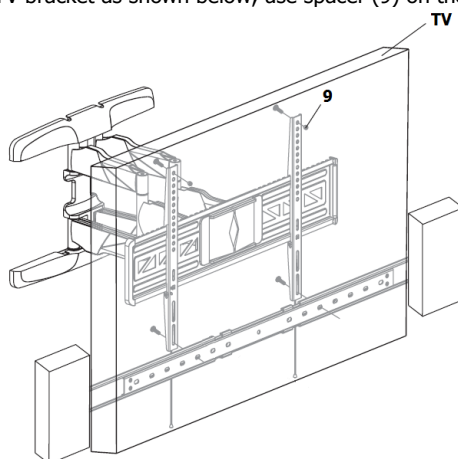

Alternatively, this bracket can be used as a low profile speaker wall mount to hide behind a TV set.

For concrete wall installation first of all work out the height of the installation and ensure it is level using a spirit level. Use a pencil to mark where the mounting holes will be and use an electric drill to drill a hole that is around 10.5mm in diameter and 60mm deep. Insert wall plugs into the holes and install the wall bracket as follows.

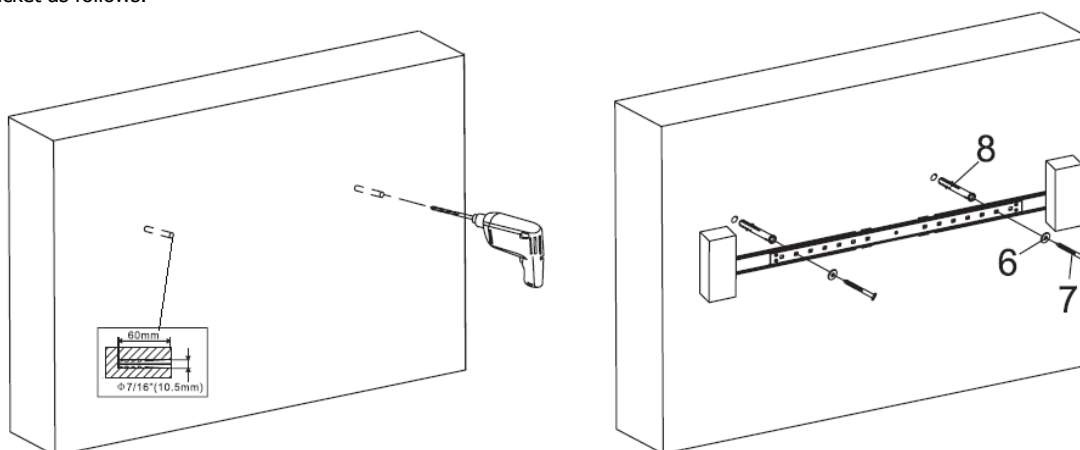

For plaster wall installation first of all find out where the wood stud is behind the wall using a stud finder. Then work out the height of the installation and ensure it is level using a spirit level. Use a pencil to mark where the mounting holes will be and use an electric drill to drill a hole that is around 4.5mm in diameter and 60mm deep. Install the wall bracket as follows.

