

SYNOSCAN

Item ref: 150.455UK

Mini Scanner with Gobos

User Manual

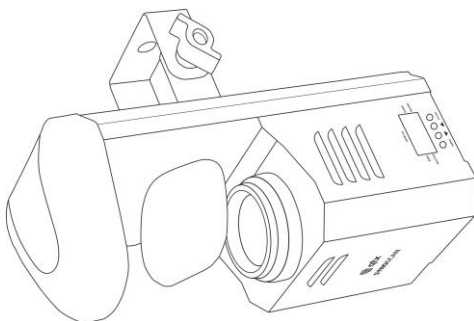

Please read through this manual thoroughly before use, any damage caused by misuse of the product will not be covered by the warranty.

A smart, compact scanner using a single powerful 10W white LED. This unit contains 7 gobos and 7 colour wheels and can be operated on auto, sound-to-light or DMX modes. When in DMX mode the built-in program automatically recognises if any additional **SYNOSCAN** or **SYNOHEAD** units are connected through DMX. Without the requirement of DMX signal, all units will automatically listen to a dedicated master to produce a synchronised light show.

- Auto, DMX, sound-to-light and master/slave controls
- 1 or 7 channel DMX control
- 7 selectable gobo patterns and 7 solid colours
- Controlled pan and tilt
- Two preset built-in slave programs allow two different light shows to sync with a single master unit
- Auto-compatible with the **SYNOHEAD** (150.454UK) for a synchronised light show
- We recommend that this product is used within the guidelines HSG95

Specifications

Power supply 100-240Vac, 50/60Hz
 Power 35W
 Fuse rating F3A
 LED power 10W
 DMX channels 1 or 7

DMX connection XLRM in, XLR out
 Gobos 7 patterns & 7 solid colours
 Dimensions 130 x 190 x 285mm
 Weight 2.05kg
 LED safety standard BSEN62471:2008

In the box

1 x **SYNOSCAN** unit with bracket, 1 x UK IEC mains lead and 1 x manual.



Please do not open the cover, contains high voltage.
This product is not serviceable or repairable by the end user.
Please refer to qualified personnel for service and repair.



To prevent risk of fire or electric shock, do not expose the unit to rain or damp environments. In the event of a spillage, disconnect the mains and allow the unit to dry out naturally. Qualified personnel should then check the unit before continuing use. Always check the correct voltage and the condition of the IEC lead before connecting to a power outlet. Always ensure any DMX leads used are in good condition with no short connections or damaged plugs.

1. DMX signal out
2. DMX signal in
3. IEC mains out
4. IEC mains in
5. Earth screw (DO NOT UNDO)
6. 4 buttons control
7. 7 segment LED display
8. Bracket
9. Second flying secure point

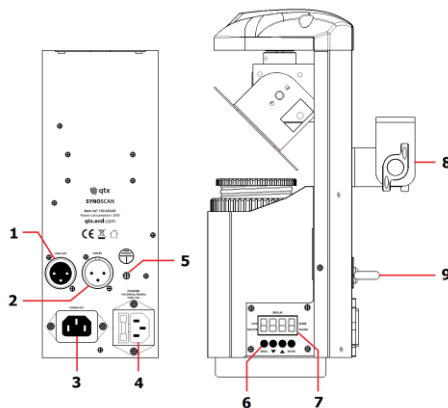

Manual control menu

Press the "menu" button to enter the setting menu.

Press "up" and "down" to navigate through the various setting options.

Press "enter" to enter the desired setting.

Choose set value by "up" and "down" buttons and confirm setting by again pressing "enter".

Display	Mode	Press ENTER for setting
Addr	DMX address	ADD 1 to RS 12
Chnd	DMX channel mode	1Ch , 8Ch or 10Ch
SLnd	Slave mode	1ASL = master, SL_1 = slave 1, SL_2 = slave 2
Shnd	Auto mode	Sh_1 to Sh_4
SPLC	Colour mode	no = Half Colour, YES = Full Colour
SoUn	Sound activation	on = sound to light on, oFF = sound to light off
SEnS	Microphone sensitivity	0 - 100 (0-100% gain)
bLnd	DMX standby mode	YES = light switches off when no DMX signal, no = enters auto mode if preset as master or slave to master unit
LEd	LED display dimmer	oFF = display off after 20s on = constant display
di SP	LED display inverted	di SP / dSi P (normal or inverted display)
PA_n	Pan reverse direction setting	no = normal pan direction, YES = reversed pan direction
tI L_t	Tilt reverse direction setting	no = normal tilt direction, YES = reversed tilt direction

TEST	Fixture test sequence	Fixture steps through all functions – press MENU to exit
hour	Fixture hours	Displays how many hours of use for the fixture
ver	Program version	Display internal program version
reset	Reset	Press enter to reset unit

Stand-alone mode

Choose whether sound-to-light is required by selecting **on** or **off** from **Sound**. Then select one of the four pre-programmed modes from **Scene** option.

Master/slave mode

More than one **SYNOSCAN** or **SYNOHEAD** can be sync together to listen to one master for synchronised light show. The smart program allows the **SYNOSCAN** and **SYNOHEAD** to recognise each other as soon as they are connecting together via DMX lead. Any unit can be set as master at any time and all the rest of the units will automatically change to slave. There are two slave settings (slave1 and slave2), which are 2 independent pre-programmed light shows to sync to the same master. Reverse pan and tilt need to be adjusted accordingly if you want certain units to mirror rather than match.

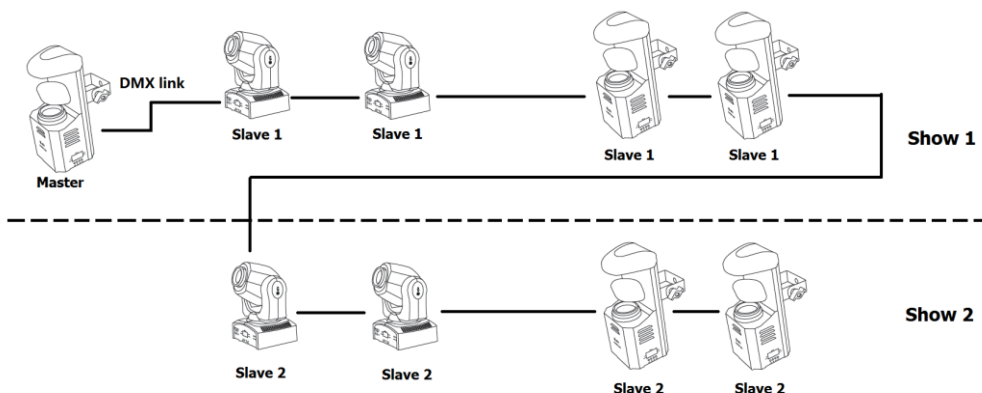

DMX mode

The **SYNOHEAD** can be control by DMX signal, simply connect the DMX signal source to the DMX in of the unit via a balanced XLR lead. Extra fixtures can be controlled by the same DMX signal by looping through the DMX out on the **SYNOHEAD**. Ensure the correct DMX start address is set from the **Addr** option on the manual control.

DMX channel value reference

1 channel mode:

Channel	DMX Value	Function
Channel 1 sound to light active from 008-255	000-007	Black out
	008-037	Show mode 1
	038-067	Show mode 2
	068-097	Show mode 3
	098-127	Show mode 4
	128-157	Show mode 5
	158-187	Show mode 6
	188-217	Show mode 7
	218-247	Show mode 8
	248-255	Random show mode 1-8

8 channel mode:

Channel	DMX Value	Function
Channel 1	000-255	Pan position
Channel 2	000-255	Tilt position
Channel 3	000-015	Gobo colour white
	016-031	Gobo colour red
	032-047	Gobo colour amber
	048-063	Gobo colour yellow
	064-079	Gobo colour green
	080-095	Gobo colour blue
	096-111	Gobo colour cyan
	112-128	Gobo colour pink
	129-255	Continues colour change, slow to fast
Channel 4	000-007, 064-071	GOBO 1 and GOBO 1 shaking
	008-015, 072-079	GOBO 2 and GOBO 2 shaking
	016-023, 080-087	GOBO 3 and GOBO 3 shaking
	024-031, 088-095	GOBO 4 and GOBO 4 shaking
	032-039, 096-103	GOBO 5 and GOBO 5 shaking
	040-047, 104-111	GOBO 6 and GOBO 6 shaking
	048-055, 112-119	GOBO 7 and GOBO 7 shaking
	056-063, 120-127	GOBO 8 and GOBO 8 shaking
	128-255	Continues GOBO change, slow to fast

Channel 5	000-007	Black out
	008-015	On
	016-131	Strobe, slow to fast
	132-139	On
	140-181	Slow fade out, fast on, speed increase with DMX value
	182-189	On
	190-231	fast off, slow fade in, speed increase with DMX value
	232-239	On
	240-247	Random Strobe
	248-255	On
Channel 6	000-255	LED dimmer 0-100%
Channel 7	000-255	Driver speed, fast to slow
Channel 8	000-239	N/A
	240-255	Sound to light mode

10 channel mode

Channel	DMX Value	Function
Channel 1	000-255	Pan position
Channel 2	000-255	Fine pan adjustment
Channel 3	000-255	Tilt position
Channel 4	000-255	Fine tilt adjustment
Channel 5	000-015	Gobo colour white
	016-031	Gobo colour red
	032-047	Gobo colour amber
	048-063	Gobo colour yellow
	064-079	Gobo colour green
	080-095	Gobo colour blue
	096-111	Gobo colour cyan
	112-128	Gobo colour pink
	129-255	Continues colour change, slow to fast
Channel 6	000-007, 064-071	GOBO 1 and GOBO 1 shaking
	008-015, 072-079	GOBO 2 and GOBO 2 shaking
	016-023, 080-087	GOBO 3 and GOBO 3 shaking
	024-031, 088-095	GOBO 4 and GOBO 4 shaking
	032-039, 096-103	GOBO 5 and GOBO 5 shaking
	040-047, 104-111	GOBO 6 and GOBO 6 shaking
	048-055, 112-119	GOBO 7 and GOBO 7 shaking
	056-063, 120-127	GOBO 8 and GOBO 8 shaking
	128-255	Continues GOBO change, slow to fast

Channel 7	000-007	Black out
	008-015	On
	016-131	Strobe, slow to fast
	132-139	On
	140-181	Slow fade out, fast on, speed increase with DMX value
	182-189	On
	190-231	fast off, slow fade in, speed increase with DMX value
	232-239	On
	240-247	Random Strobe
	248-255	On
Channel 8	000-255	LED dimmer 0-100%
Channel 9	000-255	Scanner driver speed, fast to slow
Channel 10	000-239	N/A
	240-255	Sound to light mode

Troubleshooting

No power (mains)	Check mains voltage is correct and outlet is switched on
	Check IEC lead and fuse (if fuse continually blows, refer back to your dealer)
No LED display	Press any control panel button and check LED setting in menu
No light output	Check control panel mode settings (standby, slave, sensitivity, DMX)
	Check DMX settings from controller (dimmer levels, blackout etc.)
No strobe output	Check strobe settings on control panel or from DMX controller
Unresponsive to DMX	Check DMX connection and leads
	Check that DMX mode is enabled (set "Addr" on control panel)
Overheating/ cutting out	Ensure that the unit is not too close to a heat source



This product is classed as Electrical or Electronic equipment and should not be disposed with other household or commercial waste at the end of its useful life.
The goods must be disposed of according to your local council guidelines.

*Errors and omissions excepted.
Copyright© 2015. AVSL Group Ltd*