



2.4G Wireless Gaming Mouse

500.020UK

Package

- ▶ 2.4G Wireless Gaming Mouse
- ▶ Mini receiver
- ▶ User guide

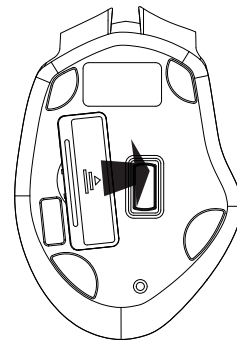
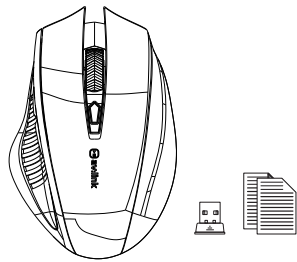

Open the battery case

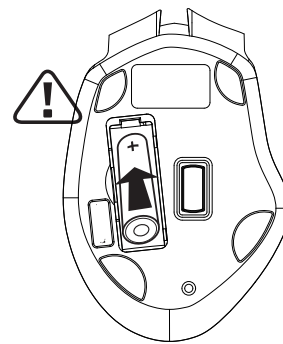

Insert the battery (pay attention to the positive and negative position)

1

2

Note: Before use, please tear up the battery insulating protective film

3

4

Remove the receiver

Insert the computer USB interface

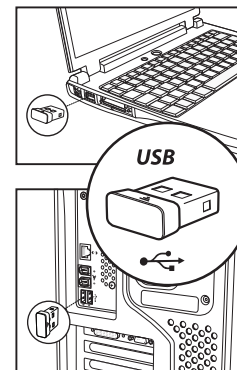
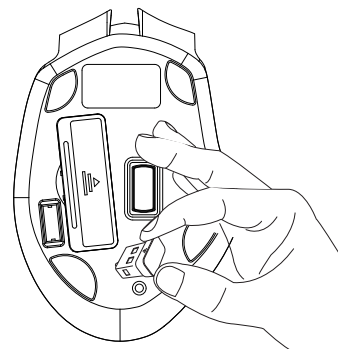

Product features

Silent button design

Adopting the silent micro switch design, 95% noiseless than ordinary switch, truly be without interference in the same room.

Stable wireless transmission

Within the scope of 20m of 360 degrees, the 2.4G wireless technology can provide stable connections.

Gaming standard DPI design

Barleo precision optical engine provides high-speed DPI designed for gamers, from 1200-1600-2000DPI switching, 2.5 times higher than ordinary optical engine that provides more precise control.

Save power by five times compared with the ordinary wireless mouse

The industry's top chip is adopted, which will save power by five times compared with the ordinary wireless mouse, with the stand-by time of 12 months.

Data parameter

Basic:

Button: 6 Buttons
 Frequency: 2402MHZ-2485MHZ
 Sensor: V108+MCU M80020
 Engine: No optical
 Distance: 20m
 Voltage: 3V
 Current: ≤8mA
 Mouse Key life: Above 3 millions
 Mouse Size: 118x73x37mm
 Mouse Weight: 69±10g

Step current:

Working current ≤8mA
 Standby current ≤80uA

Tracking performance:

Mouse Resolution: 1200-1600-2000DPI

System requirement:

IBM or compatible computer
 Windows: 2000/ ME/ XP(x64)
 / Vista / 7/ 8 /10
 Mac OS X(More than V10.4)
 Workable USB port

The actual scope of the wireless varies depending on usage and environmental conditions.

Warranty term

The equipment is provided with a limited product hardware warranty service for 1 year from the date of purchase.

Security reminder

Please do not open or repair the equipment. Please do not use the equipment in a wet environment. Please wipe the equipment using the dry cloth.

Warranty restrictions

The limited warranty doesn't cover the problems or damages due to the following causes:
 (1) Accidents, misuse, improper operation, or any unauthorized maintenance, modification or dismantling;
 (2) Improper operation or maintenance, violation of the product description during the application or improper connection of voltage source;

Compensation

(1) In case of quality problems within 7 days, according to the "three guarantees" stipulated by the country, the hardware will be returned to the purchase place under the intact appearance and packaging of the product, and the payment for the bought hardware will be returned when presenting the valid voucher for purchase.
 (2) In case of quality problems within 60 days, the hardware product can be replaced at the purchase place or repaired at the specified repairing block, and the expiration date of the replaced hardware is the remaining days.
 (3) In case of quality problems within 1 year, the product can be repaired at the specified repairing block.

warranty period	date	Maintenance situation
Date of purchase		
Where to buy		
Product Serial Number		
Product Number		
stamp		



AVSL Group Ltd
W www.avsl.com
T 0845 270 2411
E info@avslgroup.com

size : 102x142.5

open size : 204x285mm