

13.5 Inch Portable Charcoal Grill

Item ref: 799.047UK

User Manual

Assembly and Safety Instructions



- FOR OUTDOOR USE ONLY -

IMPORTANT SAFEGUARDS

Definitions

Whenever used, the following identify safety and property damage messages and designate a level of hazard seriousness.

 - This is the safety alert symbol. It alerts you to potential personal injury hazards. Obey all safety messages that follow this symbol to avoid possible injury or death.

DANGER - Indicates an imminently hazardous situation, which, if not avoided, will result in death or serious injury. Usage of this signal word is limited to the most extreme situations.

WARNING - Indicates a potentially hazardous situation, which, if not avoided, could result in death or serious injury.

CAUTION - Indicates a potentially hazardous situation, which, if not avoided, may result in minor/moderate injury.

NOTICE - Addresses practices not related to personal injury, such as product and/or property damage.



READ ALL INSTRUCTIONS BEFORE USE.

 **DANGER**- To avoid an explosion, serious personal injury, or death:

- Do not use this product indoors or in enclosed areas (e.g. tents) even if ventilation is provided, and do not store the product indoors with freshly used coals; burning charcoal releases carbon monoxide, which is toxic to humans and animals.
- Do not use or store this product near flammable liquids, materials, or vapors.

 **WARNING**- To avoid fire, burns, or other serious personal injury:

- Keep out of the reach of children and pets. Extra caution is necessary when using this product near children.
- Do not use this product if you are under the influence of alcohol or prescription/non-prescription drugs, as these substances may impair your ability to safely use the product.
- Do not leave the product unattended while it is in use.
- Do not move the product while it is in use or hot; allow the product to cool completely before handling.
- Ensure the product is fully and securely assembled before each use.

- Keep hair, clothing, and jewelry away from the coals when lighting and away from flames.
- Do not touch hot surfaces; always wear protective, heat-resistant mitts/gloves when using this product.
- Do not use this product on or near vehicles or boats.
- Do not insert used paper, cardboard or similar materials into the flames or coals.
- Do not repair or repaint the product; discard if damaged.
- Do not build large fires in this product; it is intended for small fires only.
- Always place the product on a flat, level, stable and heat-resistant surface.
- When the appliance is in use, the handle can reach extreme temperatures that can cause serious injury to an unprotected hand. Use an appropriate heat resistant glove or pad when handling.
- The necessity for maintaining proper clearances from combustible construction is 10 feet (3 M), the specific minimum clearances from such construction to the sides and back of the outdoor appliance, and that the appliance shall not be used under overhead combustible construction.

 **WARNING:** This product can expose you to chemicals including lead and soot.

 **CAUTION-** To reduce the risk of personal injury:

- This product is intended solely for outdoor, non-commercial use in cooking foods for human consumption; do not use for any other purpose.
- Do not use water to extinguish coals or cool the product.
- Do not use attachments not recommended or sold by the product manufacturer.

NOTICE- To avoid product/property damage:

- Always use heat-resistant utensils with the product.

SAVE THESE INSTRUCTIONS FOR FUTURE REFERENCE

Parts

- | | |
|-----------------|------|
| 1. Handle | 1PC |
| 2. Air Vent | 1PC |
| 3. Lid | 1PC |
| 4. Cooking Grid | 1PC |
| 5. Bowl | 1PC |
| 6. Leg | 2PCS |

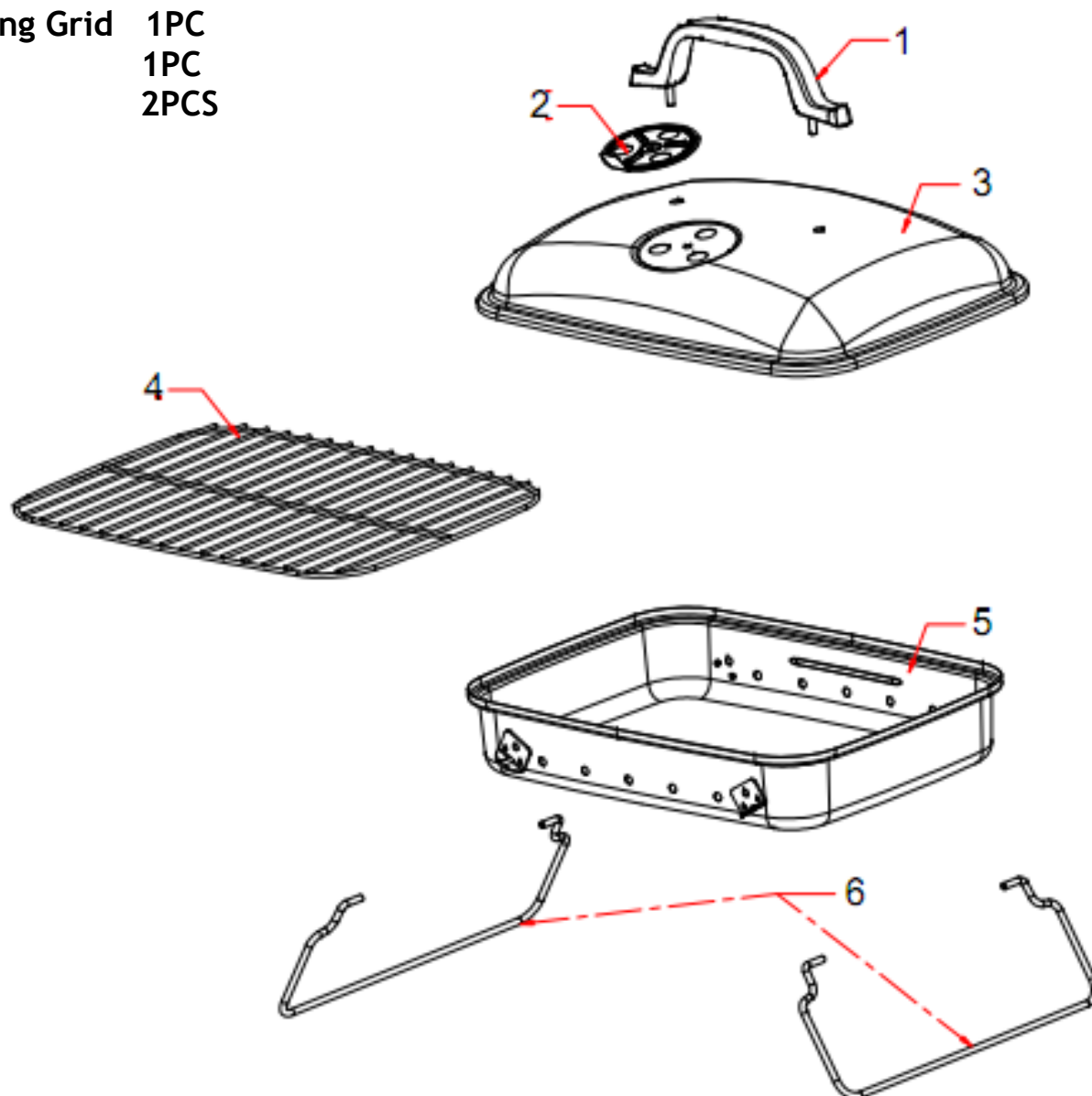

Hardware

Number	Name	QTY
A	Screw M5X10	1 PC
B	Wing nut M5	3PCS
C	Washer	2 PCS

To Assemble:

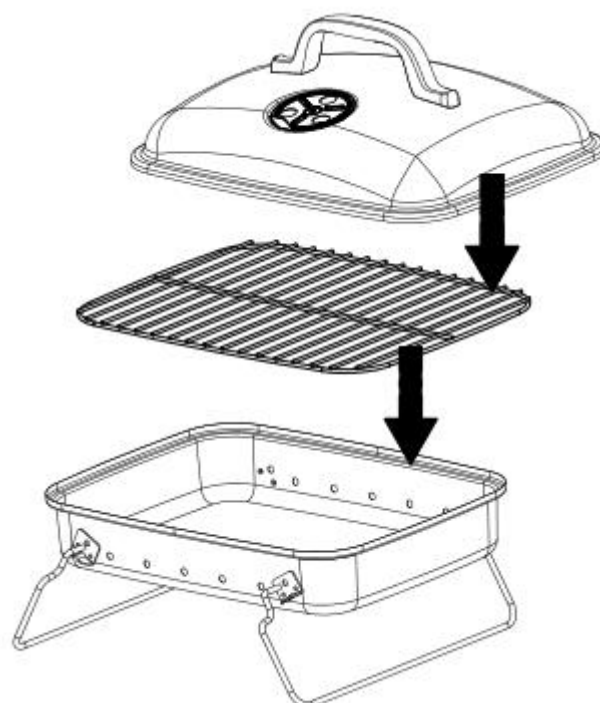
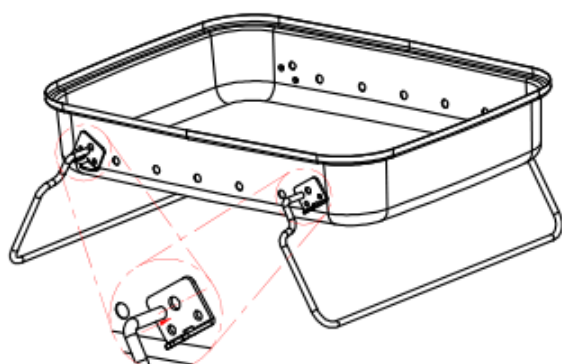
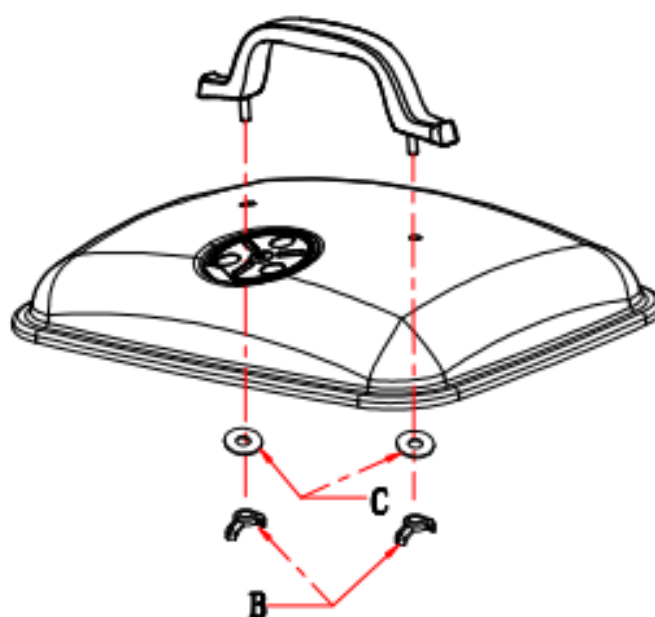
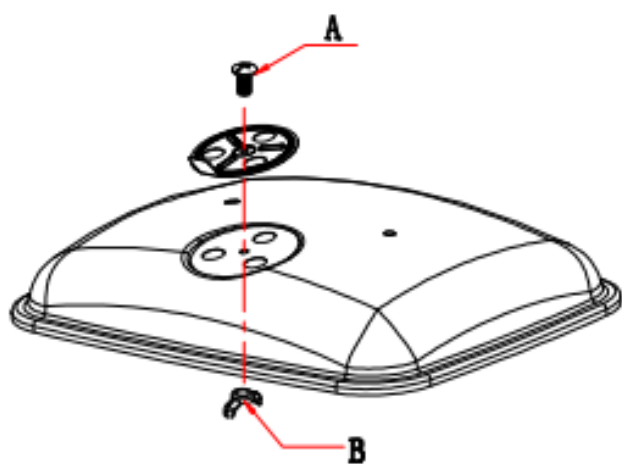

To fold-up legs and lock lid

Note: Always lock lid before folding legs

Note: Lid must be locked before transporting grill

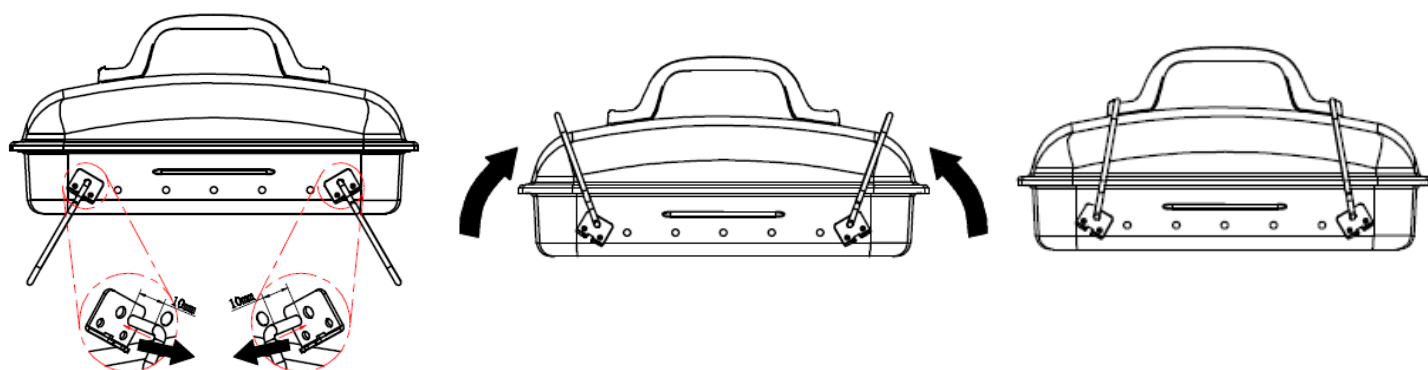

To unfold legs and lock lid

Note: Always open legs completely and secure in place before lighting grill

Note: Always unlock and open lid before lighting grill.

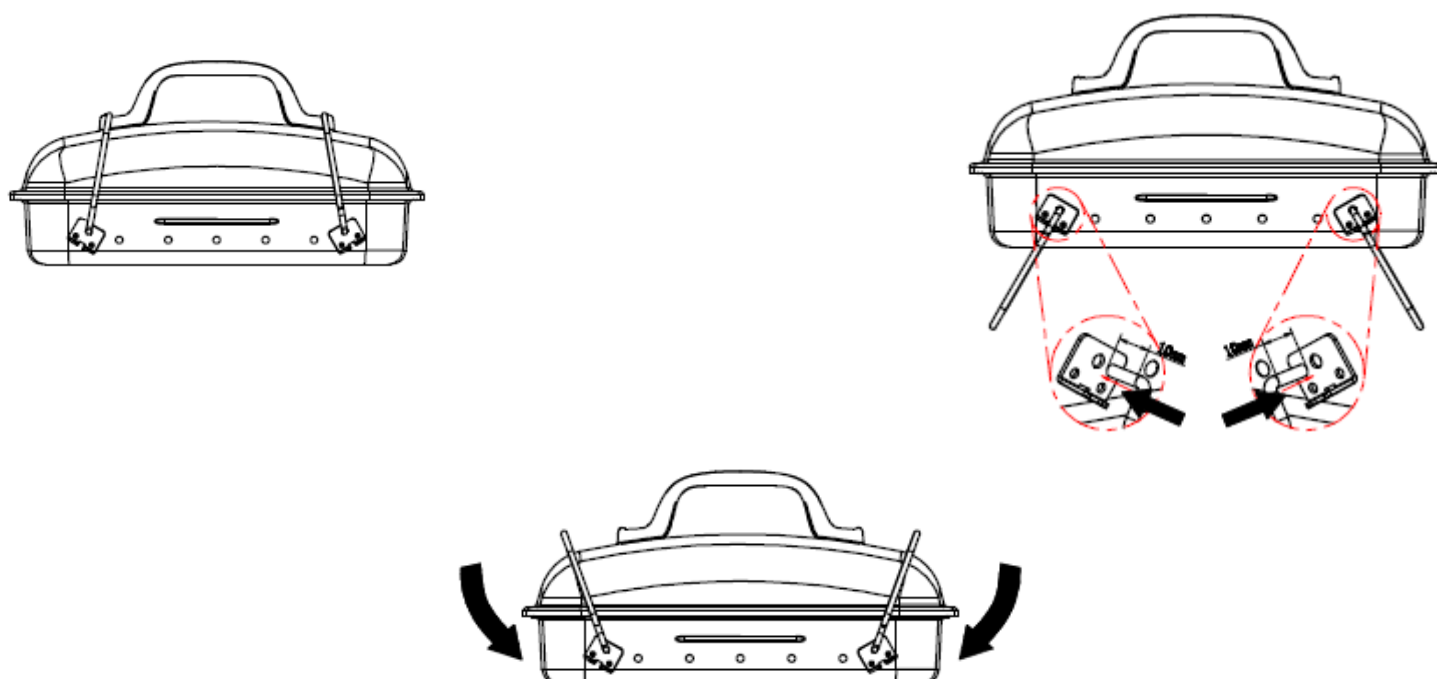

To Use:



WARNING:

- To avoid burns, always wear protective oven mitts or non-flammable, heat-resistant gloves while using the Grill.
 - Do not touch hot surfaces.
 - Always use heat-resistant utensils with the Grill.
1. Place charcoal in a pile on the Charcoal Grid.
 2. If using charcoal lighter fluid, add it before lighting the charcoal.
WARNING: Never use lighter fluid on a fire or on embers.
 3. Carefully light the charcoal. Flames can rise quickly; keep hair, clothes, face and body away from the flames.
 4. When the charcoal turns white around the edges, it is ready for cooking. Use a heat-resistant utensil with a long handle to spread the charcoal evenly on the Charcoal Grid. Then place the Cooking Grid onto the Bowl.
 5. Place the food to be cooked onto the Cooking Grid.
 6. Add or remove the Lid as desired.
 7. Use the Vents to adjust the heat of the coals. Opening the Vents allows more oxygen to get to the coals, causing them to burn hotter and faster. Closing the Vents limits the oxygen to the coals and lowers their temperature, causing them to burn longer, but not as hot.
 8. When finished cooking, remove the food by using your heat-resistant utensil. Allow the Grill to cool completely and then discard the ashes.
 9. Clean as described below frequently.

Care and Maintenance

WARNING: Allow the product to cool completely before relocating or cleaning it.

CAUTION: Inspect regularly for loose parts, tightening them as necessary.

Cleaning and Storage:

- After a few uses, clean the Lid, Bowl, Cooking Grid and Charcoal Grid by using a sponge with warm water and a mild soap. For baked-on debris, soak the parts in warm water and then scrub with a mild scrubbing sponge. If needed, use a heavy-duty scrubbing pad to clean the Grids only. Rinse and dry thoroughly. Clean the remaining parts by wiping with the soft side of a damp sponge.

NOTICE: Do not use abrasive cleaners or solvents to clean the product.

- Store in a dry and sheltered location when not in use.

Rust on Metal Finishes:

Rust and corrosion are unavoidable when metal products are used outdoors. All metal will rust or corrode in some manner over time with exposure to the elements. To help prevent rust and corrosion:

- Keep the product out of rain and other inclement weather as much as possible.
- Avoid causing nicks in the metal where corrosion or rust may form.