

Lux

Light Sensor Control Lamp Holder

Item ref: 522.011UK

User Manual

Introduction

Thank you for choosing the Primalux Light Control Sensor Lamp Holder. This lamp holder can help save energy in many different environments such as; the home, the workplace and hotels etc.

The lamp holder only allows the light to illuminate when necessary so that when insufficient light is within the room the lamp will illuminate.



Installation

- Whilst installing please ensure that the power is off to avoid any possible harm.
- Then fix the holder into the correct fitting (E27) to the install location.
- Screw in the E27 fitting and then connect an E27 lamp of your choice to the bottom of the holder.
- Please ensure that both the lamp holder and the lamp are screwed in correctly and tightly.
- Once installed, turn the power back on and check to ensure the holder functions correctly.
- Please see the right image for extra assistance on installation.

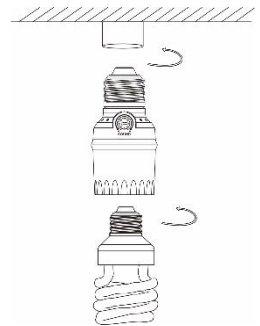

522.011UK User Manual

Testing

- After a successful installation, turn on the power for checking.
- If testing during daytime check by covering the detector with an opaque object for example a towel.

Note

- The lamp holder will only work when it is dark, if testing during daytime please cover the detection window with opaque objects.
- Please ensure that the lamp is less than 100W.

Specification

Power Source	220-240Vac (50/60Hz)
Rated Load	60W (E27)
Ambient Light	<10 Lux ON >40 Lux OFF
Detection Range	360°
Operating Temperature	-20°C to +45°C
IP Rating	IP20
Installation Height	2m-3.5m



Disposal: The "Crossed Wheelie Bin" symbol on the product means that the product is classed as Electrical or Electronic equipment and should not be disposed with other household or commercial waste at the end of its useful life. The goods must be disposed of according to your local council guidelines.

*Errors and omissions excepted.
Copyright© 2019. AVSL Group Ltd.*

522.011UK User Manual